

**3<sup>rd</sup> Annual**  
**Indiana University School of Medicine**  
**Education Day Program**

**Hine Hall Conference Center**

**Thursday, April 28<sup>th</sup>, 2022**  
**8:00 am – 5:00 pm**

***“Building Bridges in Medical Education”***



**INDIANA UNIVERSITY**  
SCHOOL OF MEDICINE

**9:00 – 9:05 AM: WELCOME FROM DEAN WALLACH**



**Paul M. Wallach, MD**

Executive Associate Dean, Educational Affairs & Institutional Improvement  
Indiana University School of Medicine

Paul M. Wallach, MD, a national leader in academic medicine and a proponent of educational innovation, joined IU School of Medicine in 2018. He is a general internist who completed medical school and residency at the University of South Florida College of Medicine. Since arriving at IUSM, Wallach has focused on introducing point of care ultrasound to our educational program and enhancing our 9-campus model through the creation of a scholarly concentrations. The 1st annual Education Day for IUSM was introduced in 2020 to highlight education as a core mission and to showcase the important work by many at our school.

**12:00 – 12:45 PM: KEYNOTE SPEAKER**



**Gary L. Dunnington, MD**

*Grosfeld Professor Emeritus of Surgery and Chair Emeritus*

***“Building a Culture of Excellence and Medical Education: The Flywheel Effect”***

Gary Dunnington, M.D. joined the faculty at the Indiana University School of Medicine in August of 2012, where he served as the Jay L. Grosfeld Professor and Chair of Surgery until his retirement at the end of 2021. He received his M.D. degree from Indiana University and completed his surgical training at the University of Arizona. Dr. Dunnington came to IU after 15 years at the University of Southern Illinois, where he served since 2000 as the Professor and Chair of Surgery. Prior to SIU, he was Associate Professor of Surgery and Senior Associate Dean for Academic Affairs for the

USC School of Medicine.

Dr. Dunnington’s area of clinical practice is surgical oncology with a focus in breast cancer. He has developed two multidisciplinary breast centers, first at the USC Norris Cancer Center and at SIU and served as Medical Director of both centers. He has served as principal or co-investigator on research projects totaling greater than 7.6 million dollars and has more than 160 peer-reviewed publications. He has received a total of 19 institutional teaching awards, having been named Outstanding Faculty Teacher of the Year nine times at four institutions, including the 2010 Outstanding Teacher of the Year award for the SIU School of Medicine and the 2011 Outstanding Teacher of the Year award at the university level. Also, in 2010, he received the AOA Robert Glazer Distinguished Teacher award from the American Association of Medical Colleges. He is a past president of the Association for Surgical Education and received the 1999 Distinguished Educator Award from this organization. He is one of the five founding faculty of the American College of Surgeons, Surgeons as Educators course and served as a faculty member for 15 years. He has been a visiting professor of education to departments of surgery in over 70 medical schools in North America.

**3<sup>rd</sup> IUSM Annual Education Day  
Thursday, April 28, 2022**

8:00-9:00 am	Slate Foyer	Registration
9:00-9:05 am	Auditorium	Welcome from Dean Wallach
9:05-9:50 am	Auditorium	1 <sup>st</sup> Selected Oral Presentations
9:50-10:00 am		Break
10:00-10:45 am	Auditorium	2 <sup>nd</sup> Selected Oral Presentations
10:45-11:00 am		Break
11:00-11:45 am	Kelley Executive Classrooms	Concurrent Workshops ( <i>Room 137</i> ) Concurrent Small Group Discussions ( <i>Room 139</i> )
11:45-12:00 pm		Break
12:00-12:45 pm	University Tower Ballroom	Lunch and Keynote Speaker
12:45-1:00 pm		Break
1:00-1:45 pm	University Tower 2 <sup>nd</sup> floor	1 <sup>st</sup> Concurrent Themed Oral Presentations: <ul style="list-style-type: none"> <li>▪ <i>Diversity, Equity &amp; Inclusion (President's Room)</i></li> <li>▪ <i>Wellness (Indiana Room)</i></li> <li>▪ <i>Simulation (Purdue Room)</i></li> <li>▪ <i>Point of Care Ultrasound (Room 219)</i></li> </ul>
1:45-2:00 pm		Break
2:00-2:45 pm	University Tower 2 <sup>nd</sup> floor	2 <sup>nd</sup> Concurrent Themed Oral Presentations: <ul style="list-style-type: none"> <li>▪ <i>Undergraduate Medical Education (President's Room)</i></li> <li>▪ <i>Graduate Medical Education (Indiana Room)</i></li> <li>▪ <i>Regional Medical Campuses (Purdue Room)</i></li> <li>▪ <i>Graduate Biomedical Education (Room 219)</i></li> </ul>
2:45-3:00 pm		Break
3:00-4:00 pm	Hallway 1 <sup>st</sup> & 2 <sup>nd</sup> floor	Poster Presentations ( <i>1<sup>st</sup> floor</i> ) Student's Scholarly Concentration Posters ( <i>2<sup>nd</sup> floor</i> )
4:00-5:00 pm	Auditorium Lobby	Reception and Certificates

**9:05 - 9:50 AM: 1<sup>st</sup> SELECTED ORAL PLATFORM PRESENTATIONS [AUDITORIUM]**

1. **Medical Students' Perspectives on a Near-Peer Facilitator Experience Aimed at Cultivating IPE-Related Skills**  
*Hannah Herriott, Margaret McNulty*
2. **Improved Interprofessional Role Comprehension through Asynchronous Case-Based Activities** *Sonali Thakur, Hannah L. Herriott, Margaret A. McNulty, Jessica N. Byram*
3. **An Evaluation of the Evaluation System – How to Improve Timely and Meaningful Evaluations of Fellows**  
*Mahvish Qureshi Rahim, Kathleen Overholt, Jodi Skiles, Brittany Manora, Amanda June Saraf*
4. **How The COVID-19 Pandemic Negatively Impacted Academic Medicine Faculty**  
*Margaret A. McNulty, Rebecca S. Lufler*
5. **Analysis of COVID-19 Case Demographics and Disease Outcomes in Gary, Indiana**  
*Maryam Sabir, Yazan Al-Tarshan, Cameron Snapp, Martin Brown, Roland Walker, Amy Han, Tatiana Kostrominova*

**9:50 – 10:00 AM: BREAK**

### **10:00 – 10:45 AM: 2<sup>nd</sup> SELECTED ORAL PLATFORM PRESENTATIONS [AUDITORIUM]**

- 1. Achieving Inclusivity in Medicine (AIM): A Student and Faculty Development Opportunity**  
*Antwione Haywood, Katherine Chartier, Emily Laughlin Stanley, Emily Walvoord*
- 2. Utilizing Mindfulness to Cultivate Cross-Cultural Empathy in Resident Education**  
*Lindsay Blazin, Julia LaMotte, Francesca Williamson*
- 3. Fostering Cultural Humility in Caring for a Returning Traveler: A Pediatric Resident Simulation**  
*Shaina Hecht, Margaret Westwater, Htayni Sui, Bobbi Byrne*
- 4. Pedagogical Advantages of the Vaccines for Children Program in a Free Student-Run Outreach Clinic**  
*Sarah E. Hopfer, Melody Wickstrom, Olivia Neese, Julie Vaughan, Kathryn Smeltzer, Asael Nunez, Nicholas Palmer*
- 5. Barriers and Opportunities in Establishing a Student-Run Free Clinic: A Collaboration with Community Partners**  
*N. Khan, A. Hossain, K. Lentsch, A. Sowers, K. Thompson, P. Prasad, J. Clemens, J. Stout*

### **10:45 – 11:00 AM: BREAK**

### **11:00 – 11:45 AM: CONCURRENT WORKSHOPS & SMALL GROUP DISCUSSIONS**

#### **CONCURRENT WORKSHOPS [ROOM 137]**

- 1. How to Implement Team Training using Interprofessional Mock Codes. A Discussion of Benefits and Best practice**  
*Daniel Germeroth, Clayre Tanis-Arens, Rania K. Abbasi, Lauren Lepper, Mark Hoyer, Ryan Alexy, Michael Ross, Rosemary Bland, Johnny Cartwright, Chris Moore, Tanna J. Boyer*
- 2. The Teaching and Evaluation of a Telemedicine Primary Care Curriculum for Indiana University Medical Students**  
*Lindsey Reese, Maria Robles*
- 3. Fostering Professional Identity Formation through an Interactive Small-Group Session**  
*Jessica Byram, J. Harry Isaacson, Neil Mehta, Chemen Neal, Antwione A. Haywood, Margaret A. McNulty, Andrew S. Deane, Richard M. Frankel*

#### **CONCURRENT SMALL GROUP DISCUSSIONS [ROOM 139]**

- 1. Formation of a Consortium of Student-Run Free Eye Clinics as a Model of Increasing Access to Specialty Care**  
*Nirupama Devanathan, Melanie Scheive, Alec Murphy, Alina Husain, Elizabeth Ann Martin, Richard Michael Schroeder, Chi Wah Yung*
- 2. Career Mentorship Utilization and Success in the Match: How Can We Best Help Students at Risk of Not Matching?**  
*Corinna Yu, Jian Ye, Sally A. Mitchell, Tanna J. Boyer*
- 3. Battling FOMO with F.O.M.O.**  
*Alison Schmidt, Paige Bradley, Anthony Shanks*
- 4. Developing a PhD Minor in Teaching and Learning for Biomedical Research PhD Students**  
*Lauren Easterling, Jessica Byram*
- 5. IUSM FAPDD RIME Faculty Learning Communities: A Great Way to Become More Involved in Med Ed Research**  
*Sally A. Mitchell, Tanna J. Boyer, Sylk M.Sotto, Komal Kochhar*

### **11:45 – 12:00 PM: BREAK**

## **12:00 – 12:45 PM: KEYNOTE SPEAKER & LUNCH [UNIVERSITY TOWER BALLROOM]**

## **12:45 – 1:00 PM: BREAK**

## **1:00 – 1:45 PM: 1<sup>st</sup> CONCURRENT THEMED ORAL PRESENTATIONS**

### **DIVERSITY, EQUITY, AND INCLUSION [PRESIDENT'S ROOM]**

*Session Leader: Matthew Holley, PhD*

*Additional Contributors:*

- 1. Latinidad y Antirracismo: Fostering Antiracism Conversations in Medical Education**  
*Alejandro Bolivar, Emily Hentz, Ruben Hernandez-Mondragón, Sylk Sotto-Santiago*
- 2. Student-Led Effort to Incorporate Social and Structural Determinants of Health into Undergraduate Medical Education: Civic Engagement, Advocacy, and Anti-Racism**  
*Lucy Brown, Trilliah Fazle, Faith Roberts, Jourdan Owens, Francesca Duncan*
- 3. Developing Self-Aware Professionalism in Care of Gender Diverse Patients: Reflections of Second Year Medical Students after a Panel Experience with Gender Diverse People and Allies**  
*Julianne Stout, Dennis Fortenberry, Donald Orr, Aletha Stahl*

### **WELLNESS [INDIANA ROOM]**

*Session Leader: Heather Kelker, MD*

*Additional Contributors:*

- 1. Exploring Work-Life Expectations among Medical Students Before and After Panel Discussion**  
*Leah Dauterman, Nabia Khan, Andrea Hodapp, Ali Jeffries, Julianne Stout*
- 2. From the Top Down: Improving Resident Wellness by Supporting Faculty with Administrative and Organizational Personnel**  
*Nicole P. Scott, Tanna Boyer, Chemen Neal, Colleen O'Brien, Emilee Delbridge, Shawn Wilson*

### **SIMULATION [PURDUE ROOM]**

*Session Leader: Dylan Cooper, MD and Nicole Kissane-Lee, MD*

*Additional Contributors:*

- 1. A Pilot Study Using Simulation to Teach Residents How to Receive Feedback Effectively**  
*Sasha Kapil, Rami Ahmed*
- 2. A Novel Way to Teach Oscillator Training via Simulation**  
*Ben D. Richter, Sally A. Mitchell, Johnny Cartwright, Chris Moore, Ray Lewis, Daniel Germeroth, Tanna J. Boyer*
- 3. Deliberate Practice of Crisis Resource Management and Team Training via Interprofessional Mock Codes in the Riley Catheterization Laboratory**  
*Clayre Tanis-Arens, Daniel Germeroth, Rania K. Abbasi, Lauren Lepper, Mark Hoyer, Ryan Alexy, Michael Ross, Rosemary Bland, Johnny Cartwright, Chris Moore, Tanna J. Boyer*

### **POINT OF CARE ULTRASOUND – POCUS [ROOM 219]**

*Session Leader: Rob Ferre, MD*

*Additional Contributors:*

- 1. The Utility of POCUS Integration into the Medical Education for Transforming the Care of Patients in Low Resource Environments**  
*Andrew Gauger, Bret Lawson, James Wilcox*

## **1:45 – 2:00 PM: BREAK**

## **2:00 – 2:45 PM: 2<sup>nd</sup> CONCURRENT THEMED ORAL PRESENTATIONS**

### **UNDERGRADUATE MEDICAL EDUCATION [PRESIDENT'S ROOM]**

Session Leader: Bradley Allen, MD, PhD

Additional Contributors:

- 1. Assessment Analysis Supports Virtual Radiology Clerkship as a Viable Alternative to an In-Person Clerkship**  
*Atul Agarwal, Richard Gunderman*
- 2. IUSM Canvas Page Evaluations: What Should We Include?**  
*Polly R. Husmann, Saira Butt, Christine M. Eckel, Joshua E. Mangum, Sally A. Mitchell*
- 3. Who Will Pass and Who Will Fail? Comparing Mid-Rotation NBME Practice Test Scores to NBME Subject Exam Scores in Third-Year Surgery Clerkship Students**  
*Christopher Thomas, Lindsay A. Haskett, Dominique Doster, E. Matthew Ritter, Lindsey E. Mossler, Katie Stanton-Maxey*

### **GRADUATE MEDICAL EDUCATION [INDIANA ROOM]**

Session Leader: Michelle Howenstine, MD

Additional Contributors:

- 1. Improving Attitudes and Practices in Transitions of Care in the Ambulatory Setting Among Medicine Residents with a Novel Transitions of Care Curriculum**  
*Eric Frontera, Komal Kochhar*
- 2. Diversity in Graduate Medical Education: Increasing Pathways to Improve Representation**  
*Alejandra Méndez, Darren Bost, Alvaro Tori*
- 3. Peer Mentorship in Residency Education: Emphasizing Interpersonal Connections to Mitigate Burnout**  
*Bianca Puello Yocum, Matthew Kuhar, Ashley Inman*

### **REGIONAL MEDICAL CAMPUSES [PURDUE ROOM]**

Session Leader: Elizabeth Ryan, EdD

Additional Contributors:

- 1. Students' Perception of the Anatomy Educational Environment at Regional Medical Campuses (RMC) and Main Campus**  
*Kyle A. Robertson, Elizabeth Agosto, Leslie A. Hoffman, Andrew S. Deane, Jessica N. Byram*
- 2. The Rural Medical Education Program at IUSM-Terre Haute**  
*Taihung Duong*
- 3. "Vets Restoring Vets": A Community Based Participatory Research Evaluation of Operation Combat Bikesaver's Innovative Peer Support Program**  
*Cody C. Stewart, Baraka Muvuka, Will Hutwagner, Hunter McCollum, William K. Dyer, Elizabeth R. Ryan*

### **GRADUATE BIOMEDICAL EDUCATION [ROOM 219]**

Session Leader: Tom Hurley, PhD

Additional Contributors:

- 1. Creating an Inclusive Environment for Biomedical Training**  
*Elizabeth Yeh*

## **2:45 – 3:00 PM: BREAK**

**3:00 – 4:00 PM: POSTER PRESENTATIONS [1<sup>ST</sup> FLOOR HALLWAY]**

**ED 1. Implementation of System-Level Quality Improvement in Mammograms and Other Preventative Gynecologic Services at Indiana University Student Outreach Clinic**

*Jourdan Owens, Kaitlin Wendel*

**ED 2. Critical Clinical Reasoning in a Virtual Setting Using Cases in Internal Medicine**

*Sacha Sharp, Zeb Saeed, LeeAnn Cox*

**ED 3. Student Response to Virtual and Student-led Surgery Interest Group Events**

*Neel Bhagat, Ali Roper, Megan Evans, Jess Berns, Bianca Blaettner, Nicole Blichmann, Elyse Feder, Sydney Keller, Robert Salvidar, Sara Sims, Acacia Williams, Katie Stanton-Maxey*

**ED 4. Leveraging the Surgical Nurse Educator in Undergraduate Surgical Education**

*Lindsay A. Haskett, Lindsey E. Mossler, Katie J. Stanton-Maxey*

**ED 5. Lessons Learned and Deliverables from an Online Med Ed Research Elective**

*Blake Brookshire, Sally A. Mitchell, Tanna J. Boyer*

**ED 6. Expectation Rarely Matches Reality: A Five-Year Analysis of Anatomy Exam Score Predictions by First-Year Medical Students**

*Andrew Cale, Margaret McNulty, Leslie Hoffman*

**ED 7. Learning Strategies Employed by Undergraduate Anatomy Students**

*Sabrina Woods, Jessica Byram*

**ED 8. The First Patient Project: An Introduction to Cadaveric Dissection**

*Kamna Gupta, Tracy Vargo-Gogola, Emily Beckman, Peter Schwartz*

**ED 9. Phase 2 Mentorship: Assessment of a Mentorship Model for Students Transitioning to the Clinical Years of Medical School**

*Sophia Joseph, Peter Arnold, Jon-Luc Poirier, Mitchell Gray, Antwione Haywood, Emily Walvoord*

**ED 10. Pre-Clinical Medical Students Attitudes Towards Psychiatry**

*Michael Opperman, Alyssa Smith, Brennan Schiller, Joseph McCann, David Scofield, Jonathan Chastain, Alexander Thomas, Morgan Jivens, David Schargorodsky, Larrilyn Grant, Martin Plawecki*

**ED 11. Trauma-Informed Care in the Classroom: Our Experience with a Content Warning in a Medical School Course**

*Julianne Stout, Angelika Martin*

**ED 12. Development and Implementation of Pregnancy Options Counseling Curriculum in Preclinical Medical Education**

*Sarah Komanapalli, Lucy Brown, Sarah Swiezy, Alexandra McKinzie, Julianne Stout*

**ED 13. Trailblazers in Medicine: First-Generation Students' Sense of Belonging at IU School of Medicine (IUSM)**

*Antwione Haywood, Niki Messmore, Daniella Feijoo, Lauren Henninger*

**ED 14. An Integrated Anatomy Pre-Matriculation Program for Under-represented in Medicine Students**

*Megan C. Fagalde, Jessica N. Byram, Chemen M. Neal, Antwione M. Haywood, Andrew S. Deane, Margaret A. McNulty*

**ED 15. Promoting a Sense of Belonging Among Underrepresented Medical Students Through Cross-Cultural Programming**

*Nabia Khan, Kaitlin Wendel, Antwione Haywood*

**ED 16. IUSM 2022 Planetary Health Report Card**

*Taylor Diedrich, Eashan Kumar, Stella Protopapas, Margaret Tharp*

**ED 17. Scholarly Concentrations Program: A PRIME Approach to Addressing Care for the Medically Underserved and Vulnerable Populations**

*Deborah R. Birnbaum, Michelle Rojas, Paul M. Wallach, Bradley L. Allen*

**ED 18. Advancing Cultural Competence in Medical Students through the AHEC Scholars Program**

*Danielle Bruno, Jennifer Taylor*

**ED 19. Medical Student Knowledge and Perceptions on Fertility and the Medical Curriculum**

*Claire Marks, Priyanka Prasad, Julianne Stout*



**ED 20. Medical Student Concerns for Respiratory Protection on Anesthesiology Electives**

*Corinna Yu, Timothy Webb, Daniel Guillaud, Sally Mitchell*

**ED 21. The Impact of COVID-19 on Food Pantry Utilization**

*Collin Wilkins, Victor Olafusi, Nikki Messmore*

**ED 22. The Impact of a Common Read on Students' Perceptions of Caring for the Incarcerated**

*Niki Messmore, Madeline Birch, Erin Brown, Jordan Crabtree, Hannah Davis, Adaline Heitz, Micah Hoeksema, Eashan Kumar, Aish Thamba, Kierra Butler*

**ED 23. IU School of Medicine Correctional Medicine Student Outreach Project**

*Rebecca Nunge, Kayla Gates, Niki Messmore*

**ED 24. Regional Medical Campuses and the Match**

*Debra Rusk, Komal Kochhar, Emily Walvoord*

**ED 25. Career Mentors and 5-Year Data on the IUSM Anesthesiology Match**

*Corinna Yu, Jian Ye, Tanna Boyer, Sally Mitchell*

**ED 26. Point-of-Care Ultrasound Curriculum Integration for Inpatient IM Residents**

*Roudi Bachar, Anthony El-Khoury, Cameron Brown, Antonio Smith*

**ED 27. Are We Ready for a Disaster? Disaster Medicine Education in Pediatric Residencies**

*Yae Sul (Hazel) Jeong, Roxanna Lefort*

**ED 28. Parental Leave During Anesthesiology Fellowship**

*Corinna Yu, Frank Rigueiro*

**ED 29. Experiences of Residency Program Directors during the COVID-19 Pandemic**

*Kyle A. Robertson, Jessica N. Byram*

**ED 30. Infant Formula Mixing and Storage Safety**

*Erik Andrews*

**ED 31. Assessment of Cystic Fibrosis Courses in Addressing Knowledge and Practice Gaps**

*Bitia Zakeri, Rima Patel, Michelle Howenstine*

**ED 32. A Simulation Case of Cricothyrotomy in an Acute Upper GI Bleed**

*Corinna Yu, Frank Rigueiro, Kevin Backfish-White, Tanna Boyer*

**ED 33. Facilitator Training in Mind Body Medicine**

*Antwione Haywood, Emily Walvoord, Samia Hasan, Emily Laughlin-Stanley*

**ED 34. A Q Methodology Approach to Assessing Attitudes Regarding the Return to In-person Learning Among Physician Assistant Students**

*Elizabeth R. Agosto, Greg J. Wehrman, Margaret A. McNulty, Rebecca L. Rebman, Jessica N. Byram*

**ED 35. How Well Did We Adapt? Continuing Education in Health Professions during COVID-19**

*Bitia Zakeri, Leila Amir Soleimani, MacKenzie Church*

**ED 36. Predictors of Publication Rate from 2018 and 2019 IMPRS Abstracts: An Exploratory Analysis**

*Mirian Ramirez Rojas, Anne T. Nguyen, Brittney-Shea Herbert, Elizabeth C. Whipple*

**ED 37. Enhancing Resident Scholarship with a Library Partnership**

*Julia Stumpff, Emilee Delbridge, Cecelia Vetter*

**3:00 – 4:00 PM: SCHOLARLY CONCENTRATION POSTER PRESENTATIONS [2<sup>ND</sup> FLOOR HALLWAY]**

**SC 1. Characterization of Voluntary Social Distancing and Vaccination Trends Among Workers from June 2020-June 2021**

*Carly Waggoner, Shannon Gidley, Kara Garcia*

**SC 2. Analysis of COVID-19 Case Demographics in Gary, Indiana**

*Maryam Sabir, Yazan Al-Tarshan, Cameron Snapp, Martin Brown, Roland Walker, Amy Han, Tatiana Kostrominova*

**SC 3. Contraception on Campus: Marketing PATH4YOU at IUPUI**

*Stephanie M. Asdell, Kathleen Wendholt, Caitlin Bernard, Brownsyne Tucker Edmonds, Tracey A. Wilkinson, Jeffrey F. Peipert*



**SC 4. Completion of Social Drivers of Health Screenings in Pediatric Practices Participating in a Quality Improvement Initiative**

*Luke Brennan, Gabrielle Michaeli, Pooja Pandita, Kayla Powell, Madeline Evans, Shraya Patel, Hannah Putnam-Johnson, Alex Chong, Sarah Stelzner, Kara Casavan*

**SC 5. Potential Benefits of Diabetes Self-Management Education at Student-Run Free Clinics**

*Cameron Smock, Javier Sevilla-Martir*

**SC 6. Perceptions on Telehealth initiated Opioid Use Disorder Treatment during the COVID-19 Pandemic**

*Quinton Thompson, Ellen M. Ireland, Randall Stevens, Robin L. Danek*

**SC 7. Individualized Exercise and the Health of the AYA Cancer Survivor Population**

*Adam Corya, Jacob Conroy, Abigail Bolt, Jessica Ricks, Nicholas Kelly, Danielle Halsey, Tammy Sajdyk, Jamie Renbarger*

**SC 8. Utilization of ICD-10 Classification Codes for Social Determinants of Health**

*Colton Junod*

**SC 9. Practical Considerations for Mass SARS-CoV-2 Pandemic Vaccination: A Narrative Review**

*Brian P. Niebuhr, Jake A. Whiteside*

**SC 10. What a Difference a Year Makes: A Snapshot of the Trends in Vaccinations, Hospitalizations, and Mortality Rates for SARS- Cov-2 Across the State of Indiana**

*Chinade Roper, Amy Han, Martin Brown*

**SC 11. Effect of Jay County Obstetric Navigator Program on Important Delivery Metrics**

*Brooke Strader, Lynn Witty, Holmes Finch*

**SC 12. HPV Knowledge and Vaccine Acceptance at the Vanderburgh County Health Department**

*Taylor Deist, Susan Ely, Erin Reese*

**SC 13. Rural and Urban EMS Level of Comfort with Overdose Treatment**

*Brycen Ratcliffe, Robin Danek, Eric Reyes, Ellen Ireland*

**SC 14. Experiences of Healthcare Workers with Disability or Chronic Illness During COVID-19 Pandemic**

*Hannah Dempsey, Kenzie Mintus*

**SC 15. Retrospective Analysis of COVID-19 Pandemic Impact on Breast Cancer Screening in Urban Northwest Indiana**

*Daniel Green, Amy Han*

**SC 16. Learning by Doing: Local Stories from SARS-CoV-2 Pandemic Vaccination Planning**

*Jake A. Whiteside, Brian P. Neibuhr*

**SC 17. Parental Influence on Youth Athletics**

*Maddie Smith, Kathleen Eggleston*

**SC 18. Community Birth in Indiana: The Motivations of Rural Women Choosing Out of Hospital Delivery**

*Emma Eckrote, Eric Reyes, Robin Danek, Ellen Ireland*

**SC 19. Review of Electronic Health Record Methods of Data Collection**

*Justin Kryshak*

**SC 20. Association Between IL6R Polymorphisms and Cachexia Phenotype in Patients with Pancreatic Ductal Adenocarcinoma**

*Nicholas Polster, Joseph E. Rupert, Andrew R. Young, Teresa A. Zimmers*

**SC 21. Chemical-Induced Aseptic Meningitis as a Result of Intrathecal Hydromorphone Therapy: Case Report**

*Sydney Willhite, Sangeeta Juloori*

**SC 22. Identifying Children with Medical Complexity for Care Coordination in Primary Care Settings**

*Mikayla Burrell, Mary Ciccarelli*

**SC 23. Rapid Review and Narrative Synthesis 2016 - 2021: Devices to Prevent Neonatal Hypothermia among Premature, Low Birthweight, and Small-for-Gestational Age Neonates in High, Middle, and Low-Income Countries**

*Emily R. Coleman, Amani N. Karim, Sherri Bucher*

**SC 24. Vascular Dysfunction in Retinitis Pigmentosa**

*Matthew Lang, Alon Harris, Thomas A. Ciulla, Brent Siesky, Pooja Patel, Aditya Belamkar, Sunu Mathew, Alice C. Verticchio Vercellin*

**SC 25. Characterizing Empiric Antimicrobials Among Newborns in Tertiary Centers in Sub-Saharan Africa**

*Grace Rushton, Osayame Ekhaguere*

**SC 26. Effect of Delay in Thrombectomy Reperfusion on Patient Functional Outcomes After Acute Ischemic Stroke**

*SD Stegelmann, G Bennett, A Runyan, B Schwartz, FL Chang*

**SC 27. Physician Moral Distress in the Care of Infants and Children born Extremely Premature**

*Anna Purk, Jane Hartsock, Brian Leland*

**SC 28. Clinical Course of Brain Fog and Associated Dysautonomia in Post-COVID Clinic Patients**

*Daniel Torolira, Britney Schwartz, Fen-Lei Chang*

**SC 29. Coarctation Angioplasty in Young Children: Does IMPACT Registry Data Accurately Reflect Clinical Outcomes?**

*Aditya Desai, Mark Hoyer*

**SC 30. Myocarditis in the Presence of Respiratory Syncytial Virus (RSV) Infection: A Case Study**

*Sean O'Brien, Amy Han, Samer Ajam*

**SC 31. Analysis and Characterization of the Utilization of Peripheral Intravenous Catheters at a Community Hospital**

*Morgan Saiko-Blair, Jered Schenk, Lexis Will, Kara Garcia, Majed Koleliat*

**SC 32. Design, Development, and Initial Results from a Pilot Study using Neonatal Pigs as a Pre-Clinical Model for Newborn Hypothermia**

*Grant Tomlin, Nicholas David Bluhm, Sherri Bucher, Jacqueline Linnes*

**SC 33. Method Development Involving Modelling Bacterial Metabolite Regulation of Vaginal Epithelial Cell Signaling in Bacterial Vaginosis**

*Alan Trinh, Doug Brubaker*

**SC 34. Role of Shp2 and Morrbid in Jak2V617F Mediated Myeloproliferative Neoplasms**

*Abigail Hadley, Fabi Aguilera, Reuben Kapur, Zhigang Cai*

**SC 35. Changes in Receptive Field Size in a Syngap1 +/- Mouse Model of Autism Spectrum Disorder**

*Evan Anderson, Charles A Martin, Maria Dadarlat*

**SC 36. Continuing Education and its Potential for Improving LGBTQ+ Healthcare: A Review**

*Tari M Kurman, Jessica J Hille*

**SC 37. The Use of Protective Orders to Obviate Investigations of Healthcare in Indiana Prisons**

*Mary Ann Etling, Jane Hartsock*

**SC 38. Trends of COVID-19 Vaccination Hesitancy among White, Black, and Latinx Americans**

*Ferris Nimri, Angeline Larimer*

**SC 39. The Happy Doctor and his Patients: Erotic Post Cards of a Physician**

*Autumn Austin*

**SC 40. Investigating the Effectiveness of Case-Based Learning Sessions for Integrating Anatomy Content**

*Emily R Merritt, Margaret A. McNulty, Chemen M. Neal, Andrew S. Deane, Antwione A. Haywood, Jessica N. Byram*

**4:00 – 5:00 PM: RECEPTION & CERTIFICATES [AUDITORIUM LOBBY]**

Presented by Paul Wallach, MD

**PLANNING COMMITTEE**

Komal Kochhar, MBBS, MHA (Chair)

Bobbi Byrne, MD

Katie Pettit, MD

Dimitrios Stefanidis, MD, PhD

Bitia Zakeri, PhD

Paul Wallach, MD

**ACKNOWLEDGEMENTS**

Continuing Medical Education (CME): Leila Amir Soleimani and CME Team

Research in Medical Education (RIME) Team

**SPECIAL THANKS**

To IUSM faculty who served as abstract reviewers

University Tower

FIRST FLOOR

Hine Hall

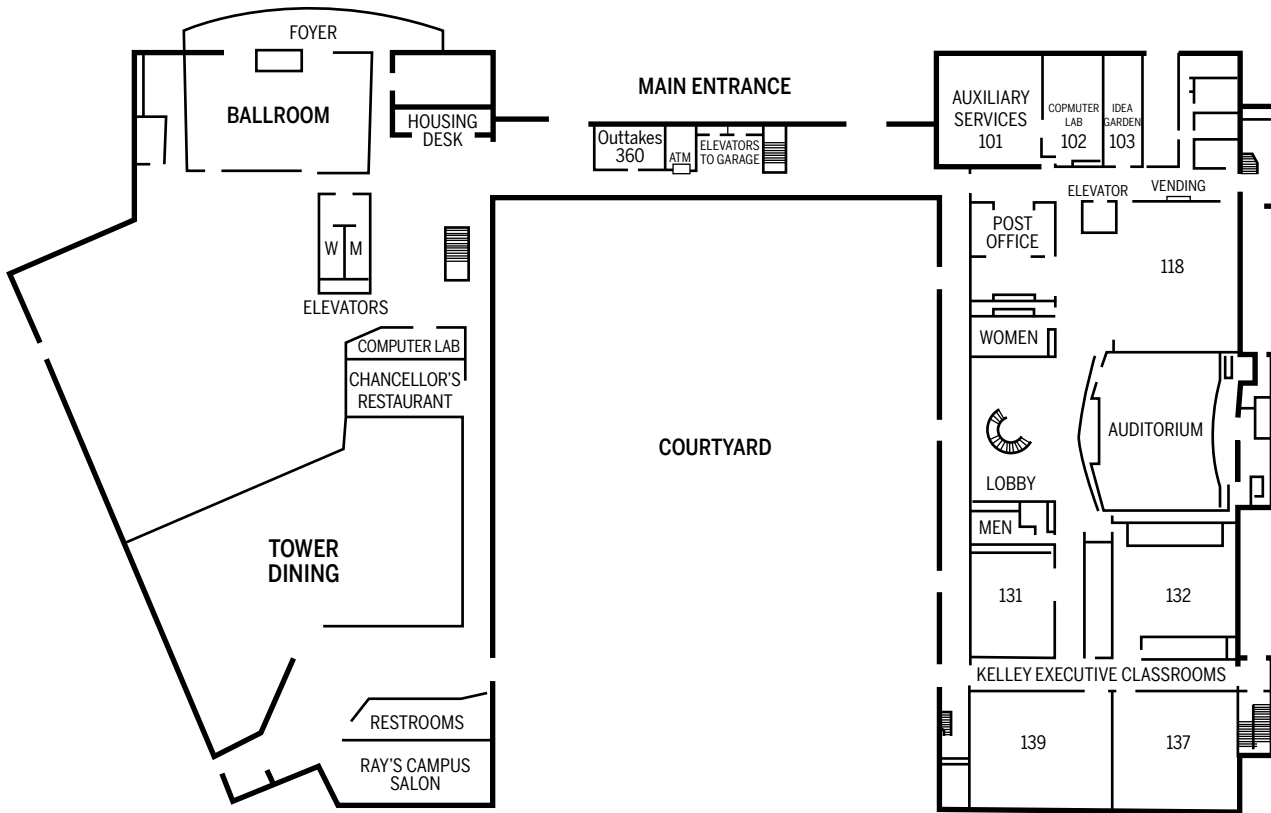

University Tower

SECOND FLOOR

Hine Hall

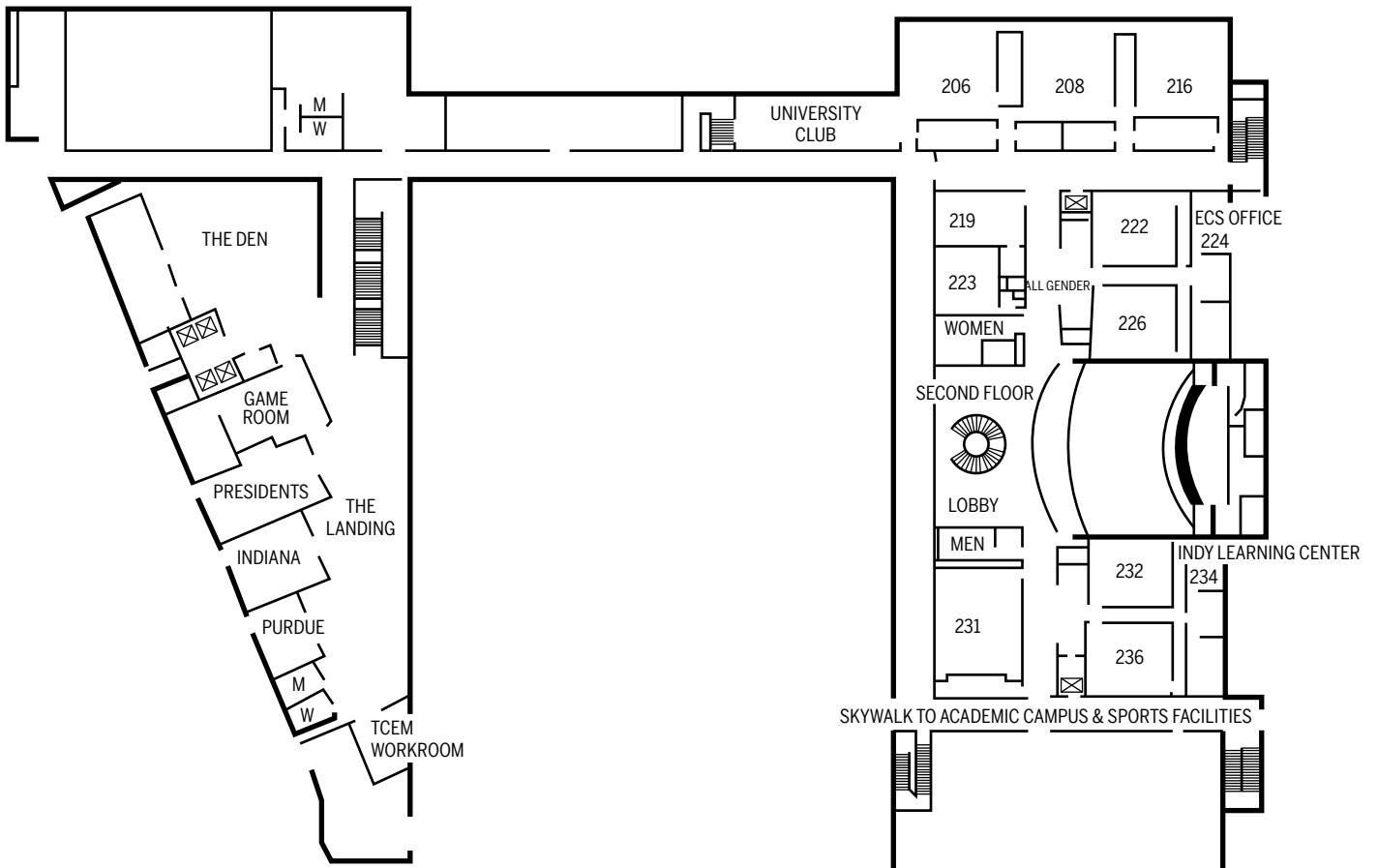

# Continuing Medical Education Learner Information

## Course Objectives:

- Identify examples of best practices in medical education
- Recognize the current approaches to assessing and evaluating learners
- Describe how educational outcomes data can be presented and published
- Network and collaborate with educators from other IUSM departments and campuses

## Accreditation Statement



In support of improving patient care, Indiana University School of Medicine is jointly accredited by the Accreditation Council for Continuing Medical Education (ACCME), the Accreditation Council for Pharmacy Education (ACPE), and the American Nurses Credentialing Center (ANCC), to provide continuing education for the healthcare team.

## Physicians

Indiana University School of Medicine designates this live activity for a maximum of 5.75 *AMA PRA Category 1* Credits™. Physicians should claim only the credit commensurate with the extent of their participation in the activity.



**INDIANA UNIVERSITY**  
SCHOOL OF MEDICINE